

CROWN LINK®

專業薄膜開關連接器第一品牌

ROHS

- ◆ Specifications:
 - Operating Voltage: 50V
 - Current Rating: 0.5A
 - Withstand Voltage: 500V
 - Contact Resistance: 30mΩ
 - Insulation resistance: 500MΩ
 - Operating Temperature: -25°C ~ +85°C

- ◆ PART NO.
 - F1.0 - XXSADTJ
 - MOLD NO.
 - TUBE
 - DRAWER
 - HORIZONTAL TOP CONTACT
 - SMT
 - CIRCUITS NUMBER 04 TO 35
 - 1.0 mm SPACING
 - FFC CONNECTOR

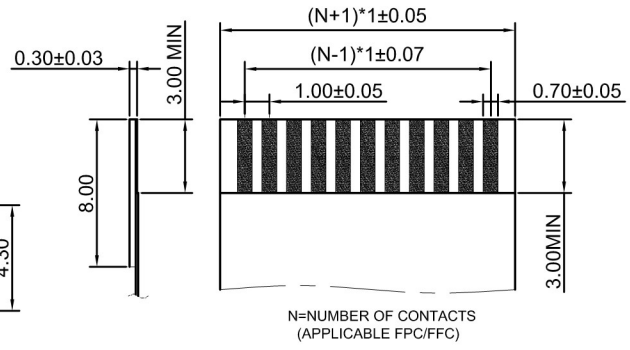
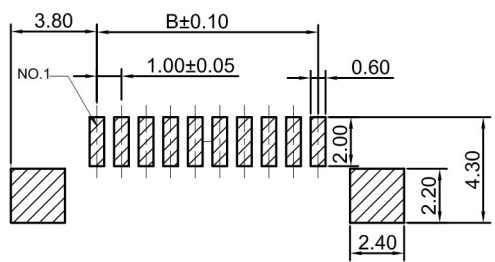
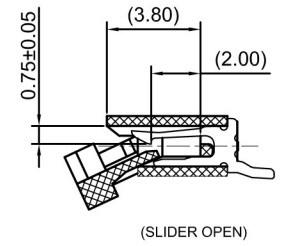
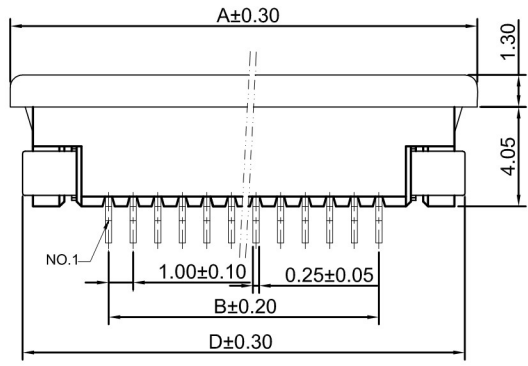
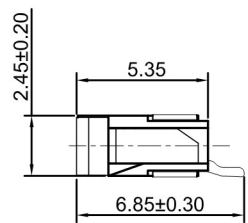
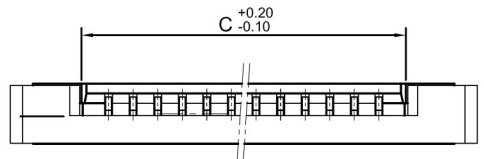

孔位	A	B	C	D
4	11.0	3.0	5.35	9.8
5	12.0	4.0	6.35	10.8
6	13.0	5.0	7.35	11.8
7	14.0	6.0	8.35	12.8
8	15.0	7.0	9.35	13.8
9	16.0	8.0	10.35	14.8
10	17.0	9.0	11.35	15.8
11	18.0	10.0	12.35	16.8
12	19.0	11.0	13.35	17.8
13	20.0	12.0	14.35	18.8
14	21.0	13.0	15.35	19.8
15	22.0	14.0	16.35	20.8
16	23.0	15.0	17.35	21.8
17	24.0	16.0	18.35	22.8
18	25.0	17.0	19.35	23.8
19	26.0	18.0	20.35	24.8
20	27.0	19.0	21.35	25.8
21	28.0	20.0	22.35	26.8
22	29.0	21.0	23.35	27.8
23	30.0	22.0	24.35	28.8
24	31.0	23.0	25.35	29.8
25	32.0	24.0	26.35	30.8
26	33.0	25.0	27.35	31.8
27	34.0	26.0	28.35	32.8
28	35.0	27.0	29.35	33.8
29	36.0	28.0	30.35	34.8
30	37.0	29.0	31.35	35.8
31	38.0	30.0	32.35	36.8
32	39.0	31.0	33.35	37.8
33	40.0	32.0	34.35	38.8
34	41.0	33.0	35.35	39.8
35	42.0	34.0	36.35	40.8

PCB LAYOUT

REV/版本	MODIFIED CONTENT /變更內容	DRAWN/繪圖	DATE/日期	TOLERANCE RANGE/公差範圍
A	FIRST DRAWING	MARY	2018.03.01	X. ±0.5 .X ±0.3 .XX ±0.2 ANGLES ±5°

DRAWN/繪圖	DATE/日期
MARY	2018.03.01
CHECK BY/審查	DATE/日期
VIVIAN	2017.03.01
APPROVED BY/核淮	DATE/日期
JASON	2017.03.01
PACKAGE/包裝	TUBE

CROWN LINK® THE LEADING MANUFACTURER OF FPC & FFC CONNECTOR, HOUSING AND DOME.				
PRODUCT NAME/品名				
FPC 1.0mm PITCH TOP OF CONTACT SMT				
PART NO./料號	PIN NUMBER/針數	SCALE/比例	SIZE/圖號	UNIT/單位
F1.0-XXSADTJ	04-35		A4	mm
MATERIAL/材質	COLOR/顏色	ANGLE OF VIEW/視角	SHEET/頁碼	REV/版本
PA6T UL94V-0 COPPER ALLOY	N/A		1 OF 1	A