

4

3

2

1

CROWN LINK[®]

專業薄膜開關連接器第一品牌

RoHS

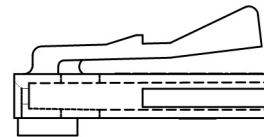
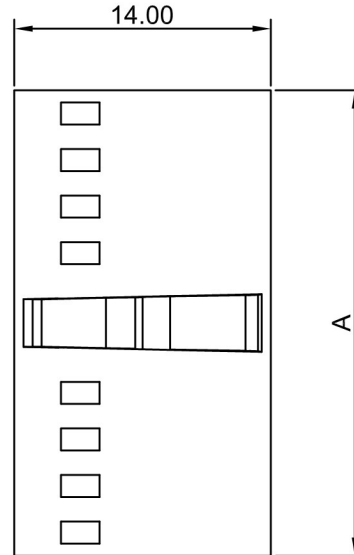
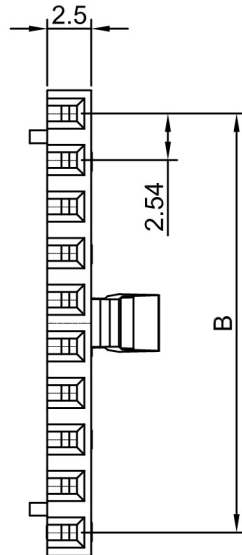
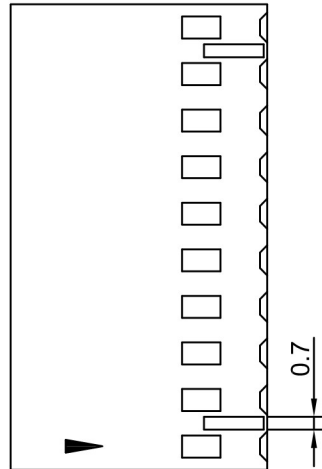
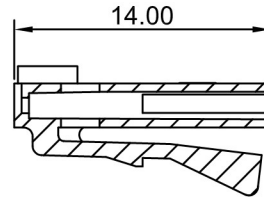

- ◆ FOR 2811 SERIES CONNECTOR
- ◆ SPECIFICATIONS
 - VOLTAGE RATING: 250 VAC RMS
 - CURRENT RATING: 2A
 - INSULATION RESISTANCE: 500 MΩ MIN
- ◆ ENVIRONMENTAL
 - TEMPERATURE RANGE: -25°C~+85°C
- ◆ DIMENSION: N=CIRCUIT NO.
 - A=2.54*N
 - B=2.54*(N-1)
- ◆ PART NO.
 - 2802HL - XXHN
 - SERIES NO. | WITH HOLE
 - NO LOGO.
 - CIRCUITS NUMBER 04 TO 17

				一般公差 ± 0.2
B	FIRST DRAWING	MARY	2019.02.19	
REV/版本	MODIFIED CONTENT /變更內容	DRAWN/繪圖	DATE/日期	

TOLERANCE RANGE/公差範圍

DRAWN/繪圖	DATE/日期	CROWN LINK[®] THE LEADING MANUFACTURER OF FPC & FFC CONNECTOR, HOUSING AND DOME.						
MARY	2019.02.19	PRODUCT NAME/品名 2.54mm PITCH HOUSING FOR FFC/FPC						
CHECK BY/審查	DATE/日期	PART NO./料號	PIN NUMBER/針數	SCALE/比例	SIZE/圖號	UNIT/單位		
VIVIAN	2019.02.19	2802HL-XXHN	04-17 PIN	3:1	A4	mm		
APPROVED BY/核准	DATE/日期	MATERIAL/材質	COLOR/顏色	ANGLE OF VIEW/視角	SHEET/頁碼	REV/版本		
JASON	2019.02.19	PA66 UL 94V-0	BLACK COLOR		1 OF 1	B		
PACKAGE/包裝	04-06 PIN 1,000 PCS/BAG 07-17 PIN 500 PCS/BAG							

D

D

C

C

B

B

A

A