

4

3

2

1

CROWN LINK[®]

專業薄膜開關連接器第一品牌

ROHS

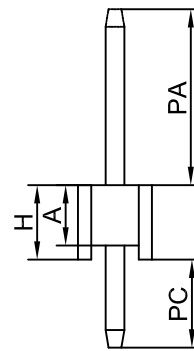
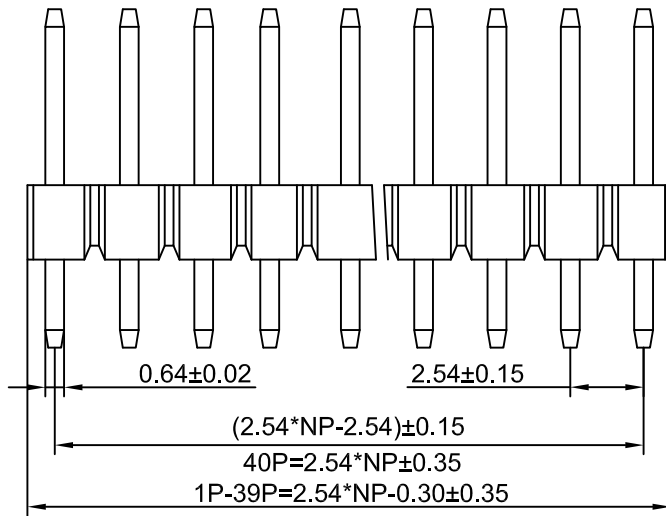
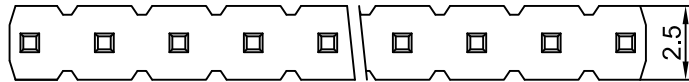

◆ Specifications

- 1. Current Rating: 3Amps
- 2. Insulation Resistance: 1000 MΩ min
- 3. Dielectric withstanding Voltage: AC 500V
- 4. Contact Resistance: 30 mΩ max
- 5. Operating Temperature: -40°C to +105°C
- 6. Contact Material: Brass
- 7. Insulation Material: As follows
- 8. Plated: As follows

◆ PART NO.

L207 XX -XX 0 X X XX X

2.54mm single row	PLASTIC HEIGHT H*W	PIN NO. 01~40	0=180° 1=90° 2=SMT	MATERIAL 1、PBT 3、NY6T 4、LCP 5、NY66 7、NY46 8、NY9T	PLATED 0、Au0.8u" 1、Au1u" 2、Au1.5u" 3、Au2u" 4、Au3u" 5、Au5u" 6、Au10u" 7、Selective gold 8、Tin 9、Matte-Tin	SERIES NO. 01~69: Without a column 70~99: With inside column	PACKAGE A=bag B=tubes C=tray D=reel
-------------------	-----------------------	------------------	--------------------------	--	--	--	---

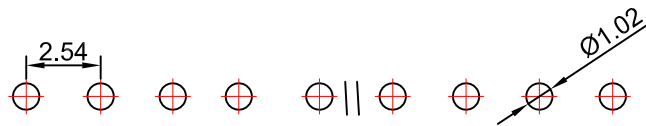

PCB LAYOUT

				LINER	ANGLES
				.0 ±0.30	0.° ±3°
A	FIRST DRAWING	MARY	2017.08.16	.00 ±0.20	.0° ±2°
REV/版本	MODIFIED CONTENT /變更內容	DRAWN/繪圖	DATE/日期	.000 ±0.10	.00° ±1°
				TOLERANCE RANGE/公差範圍	

DRAWN/繪圖	DATE/日期
MARY	2017.08.16
CHECK BY/審查	DATE/日期
VIVIAN	2017.08.16
APPROVED BY/核准	DATE/日期
WENDY	2017.08.16
PACKAGE/包裝	

THE LEADING MANUFACTURER OF FPC & FFC CONNECTOR, HOUSING AND DOME.				
PRODUCT NAME/品名 PH2.54*H 1×NP 180° SINGLE ROW PIN HEADER				
PART NO./料號	PIN NUMBER/針數	SCALE/比例	SIZE/圖號	UNIT/單位
L207XX-XX0XXXXX	01P-40P		A4	mm
MATERIAL/材質	COLOR/顏色	ANGLE OF VIEW/視角	SHEET/頁碼	REV/版本
	BLACK COLOR		1 OF 1	A