

CROWN LINK®

專業薄膜開關連接器第一品牌

ROHS

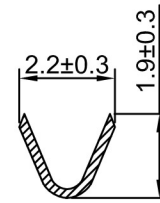
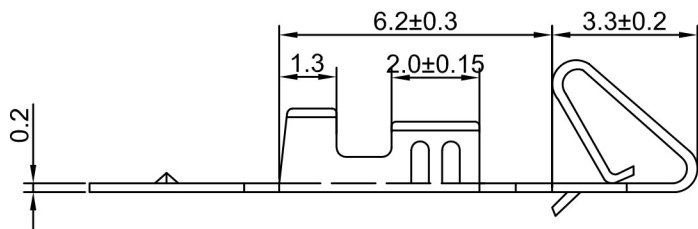
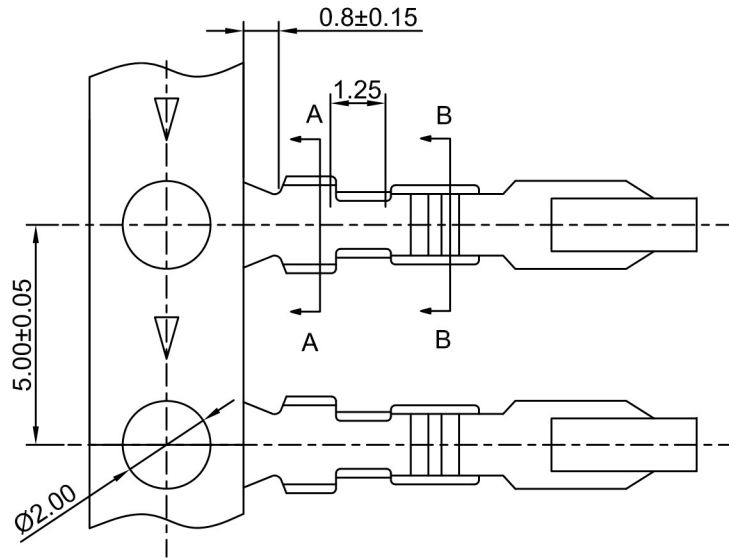

A-A SECTION

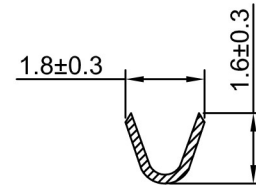

B-B SECTION

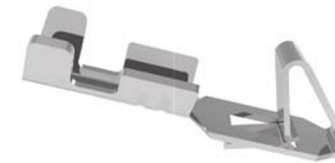

0T:TIN PLATED

- ◆ FOR 2803 SERIES HOUSING
- ◆ SPECIFICATIONS
INSULATION O.D: 1.50mm(MAX)
WIRE RANGE:AWG#22~#28

◆ PART NO.

280301 - 10K - 0T - FS

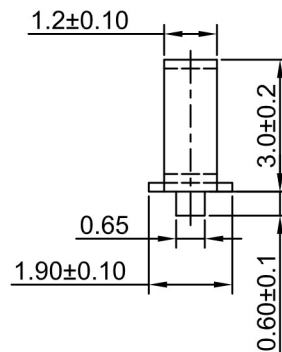
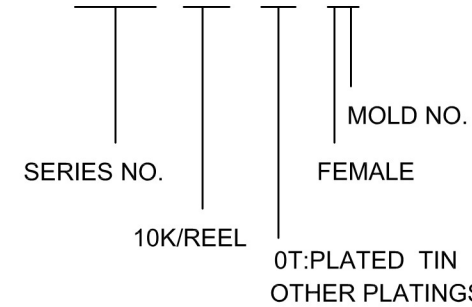

| | | | | |
|--------|------------------------|----------|------------|----------------------|
| | | | | X. ±0.50 |
| | | | | .X ±0.30 |
| | | | | .XX ±0.20 |
| A | FIRST DRAWING | LACY | 2020.07.15 | |
| REV/版本 | MODIFIED CONTENT /變更內容 | DRAWN/繪圖 | DATE/日期 | TOLERANCE RANGE/公差範圍 |

| | | | | | |
|-------------------------|-----------------------|---|----------------------|--------------------|---------------|
| DRAWN/繪圖 LACY | DATE/日期 2020.07.15 | CROWN LINK® THE LEADING MANUFACTURER OF FPC & FFC CONNECTOR, HOUSING AND DOME. | | | |
| CHECK BY/審查 VIVIAN | DATE/日期 2020.07.15 | PRODUCT NAME/品名 5mm PITCH FFC/FPC CONNECTOR | | | |
| APPROVED BY/核准 JASON | DATE/日期 2020.07.15 | PART NO./料號 280301-10K-0T-FS | SCALE/比例 6:1 | SIZE/圖號 A4 | UNIT/單位 mm |
| PACKAGE/包裝 | 10,000PCS/REEL | MATERIAL/材質 BRASS | ANGLE OF VIEW/視角 | SHEET/頁碼 1 OF 1 | REV/版本 A |